

Sinclair  Hammelton

£215,000

Widmore Road

Bromley, BR1 3AD

## PROPERTY SUMMARY

Chain Free

New to the market is this one-bedroom Victorian conversion, offering excellent potential for improvement.

The property comprises a double bedroom, a bright reception room, and a bathroom. While the property would benefit from updating, it presents a fantastic opportunity for buyers looking for a blank canvas.

Additional benefits include storage, and access to communal gardens.

Ideally located within easy reach of Bromley North Station (0.4 miles), providing services to London Bridge via Grove Park and Bromley South Station (0.7 miles), offering fast and frequent connections to London Victoria and Blackfriars. Bromley town centre is also nearby, with a wide range of shops, pubs, restaurants, as well as The Glades Shopping Centre, Churchill Theatre and St Mark's Square.

1



1



0





# Widmore Road, BR1

Approximate Gross Internal Area 46.5 sq m / 501 sq ft

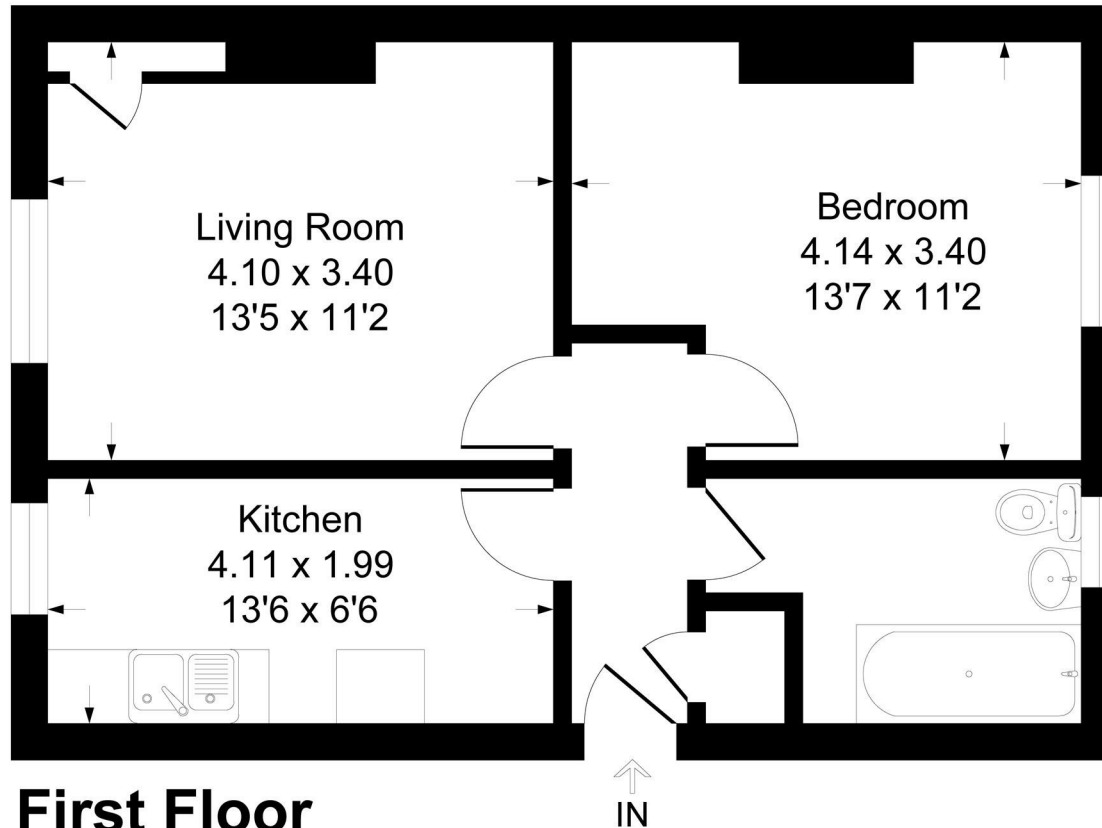

## First Floor



This plan is for layout guidance only. Not drawn to scale unless stated. Windows and door openings are approximate. Whilst every care is taken in the preparation of this plan, please check all dimensions, shapes and compass bearings before making any decisions reliant upon them.  
Produced By Planpix



**LOCAL AUTHORITY**

**TENURE**

Leasehold

**EPC RATING**

C

**COUNCIL TAX BAND**

C

**VIEWINGS**

By prior appointment only

Energy Efficiency Rating		
	Current	Potential
<i>Very energy efficient - lower running costs</i>		
(92 plus) <b>A</b>		
(81-91) <b>B</b>		
(69-80) <b>C</b>	75	80
(55-68) <b>D</b>		
(39-54) <b>E</b>		
(21-38) <b>F</b>		
(1-20) <b>G</b>		
<i>Not energy efficient - higher running costs</i>		
<b>England &amp; Wales</b>	EU Directive 2002/91/EC	

Agents Note: Whilst every care has been taken to prepare these particulars, they are for guidance purposes only. All measurements are approximate and are for general guidance purposes only and whilst every care has been taken to ensure their accuracy, they should not be relied upon and potential buyers/tenants are advised to recheck the measurements

Sinclair Hammelton

**OFFICE ADDRESS**

23 High Street  
Bromley  
Kent  
BR1 1LG

**OFFICE DETAILS**

0208 464 5566  
info@sinclairhammelton.co.uk